

HARTMANN

PUMPS - MOTORS - CONTROLS

604 Progress Dr., Hartland, WI 53029 USA

Tel: (262) 367-4299

Fax: (262) 367-5645

Email: sales@hartmanncontrols.com

URL: <http://www.hartmanncontrols.com>

FRAME 3

PVX 8128

(128 cm.³/rev.) (8.0 in.³/rev.)

VARIABLE DISPLACEMENT, AXIAL PISTON, SWASH PLATE DESIGN PUMP

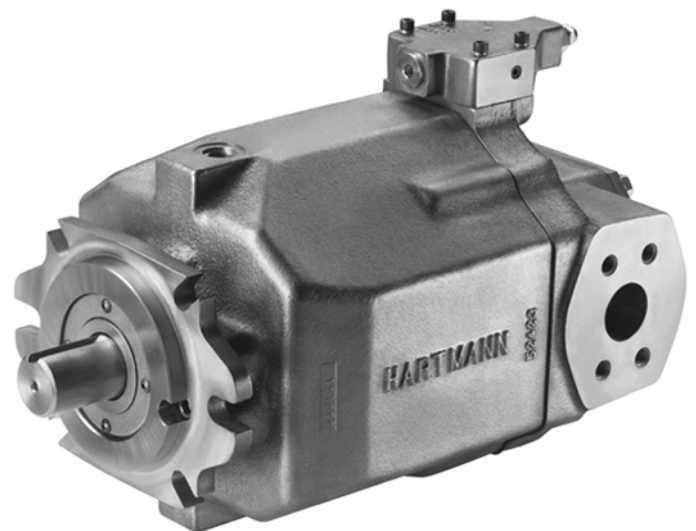
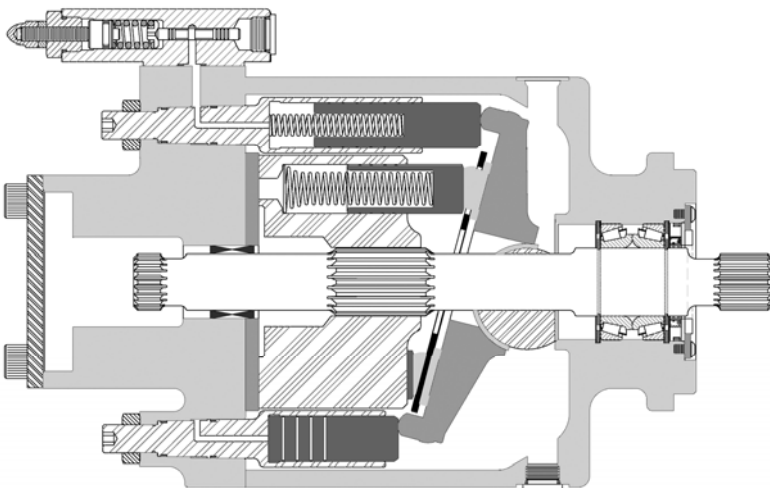

Features:

- Offered with a standard SAE 'C' 2- & 4-bolt mount.
- Incorporated in a compact design with rugged ductile iron frame.
- Offered with variety of porting configurations.
- Offered with a variety of drive shaft options.
- Is Service friendly.
- Equipped with Viton shaft seal and O-rings.
- Can be fitted with a variety of control options.
- Equipped with maximum and minimum volume stops. The latter is adjustable.

This versatile PVX pump is aimed at operating in both industrial and mobile applications. With its continuous operating pressures ranging from 500 to 3850 psi, and shaft speeds up to 2100 rpm at atmospheric inlet conditions, this pump is designed for a long and dependable service.



Pumps & Motors with a *hart of gold*

TM

FRAME 3, PVX 8128 SPECIFICATIONS

PVX	RATED PRESSURE	PEAK PRESSURE	MINIMUM PRESSURE	
8128	3850 lb/in² (265 bar)	4500 lb/in² (310 bar)	500 lb/in² (34 bar)	
PVX	DISPLACEMENT	THEORETICAL FLOW @ 1800 rpm	SHAFT SPEED	
			MAXIMUM	MINIMUM
8128	8.0 in³/rev (128 cm ³ /rev)	62.3 gal/min (236.0 l/min)	2100 rpm	700 rpm
PVX	OUTPUT TORQUE @ RATED PRESSURE	SHAFT SIZE	RECOMMENDED TORQUE LIMIT	
8128	4,903 in-lb (552.0 N-m)	SAE C SAE CC	5,500 in-lb (619.4 N-m) 9,500 in-lb (1070.0 N-m)	

Input-shaft torque may not exceed the total of front-pump torque and (if added) rear-mounted units.

MODEL SPECIFICATION CHART

PVX

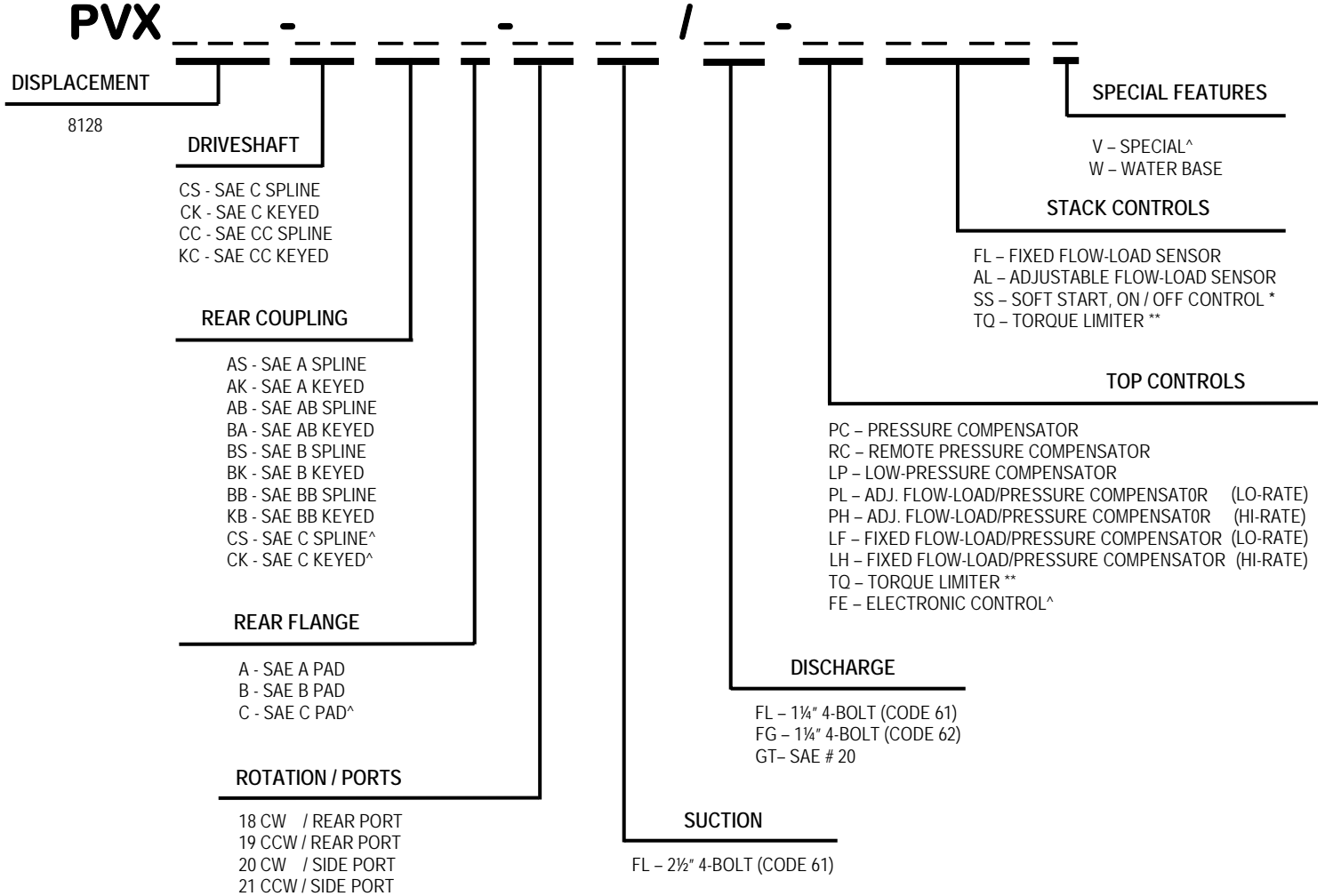

* - SPECIFY VOLTAGE, CONNECTION AND ENERGIZE OPTION

** - SPECIFY TERMINAL PRESSURE AND HORSE POWER

[^] - CONSULT FACTORY

FRAME 3, PVX 8128 PERFORMANCE

PVX8128 pump performance @ 1750 rpm using ISO 32 oil at 115° F

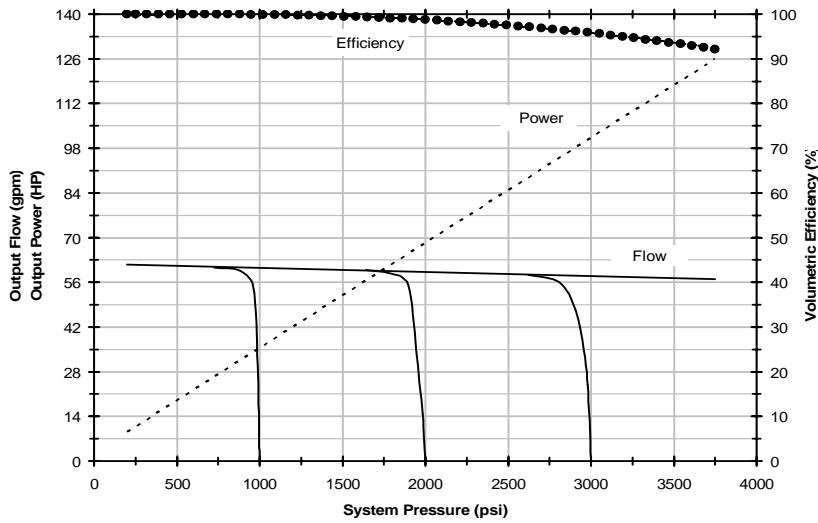

PVX8128 pump input power curves @ 1750 rpm using ISO 32 oil at 115° F

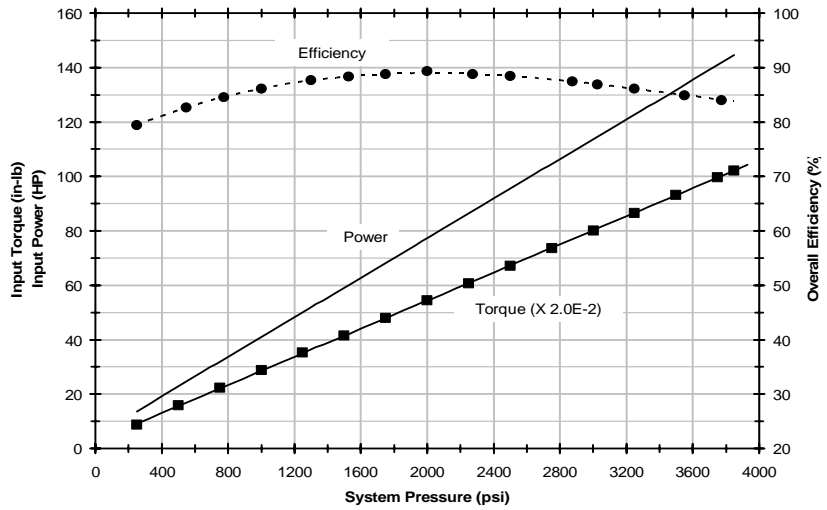

PVX8128 pump inlet characteristics based on ISO 32 Oil @ 115°F

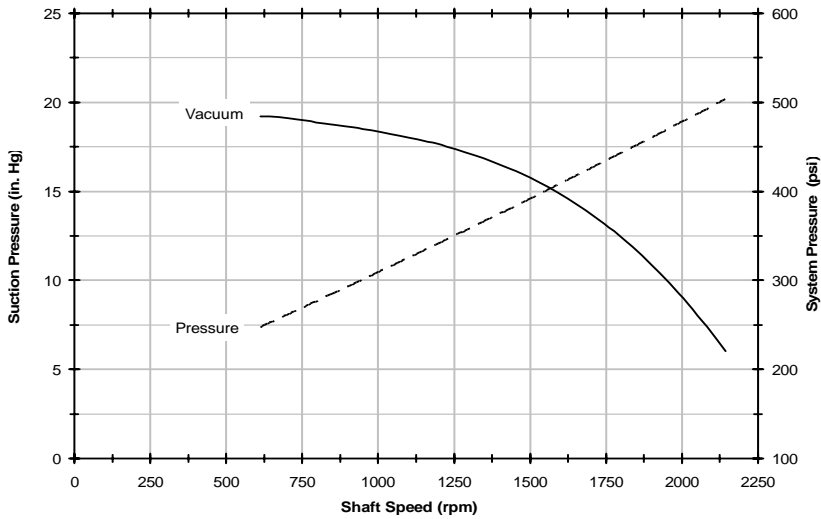

Pump typical weight: Side-Ported 150-155 lbs. Rear-Ported 145 lbs.

FRAME 3, PVX 8128 DIMENSIONS

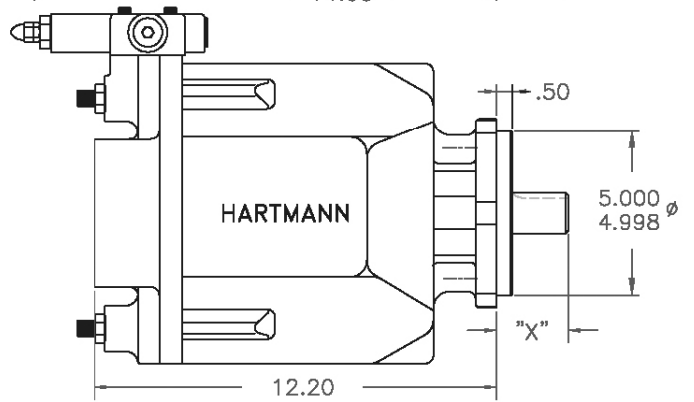
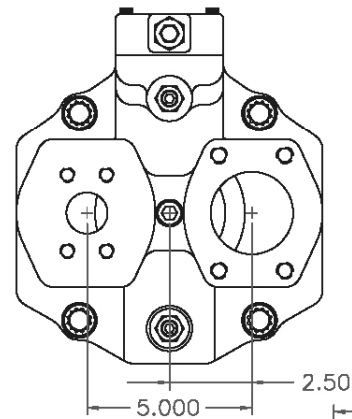
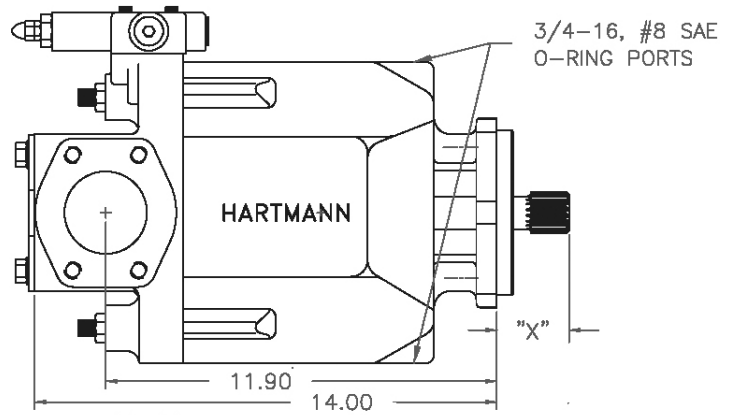
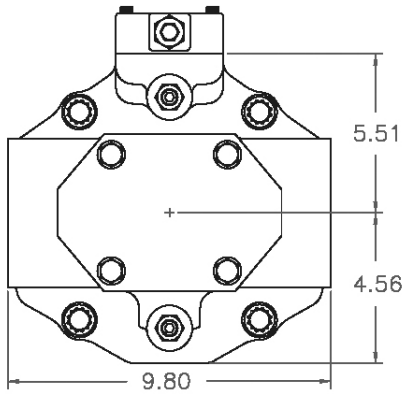

SAE 'C' 2- & 4-BOLT FRONT MOUNTING FLANGE

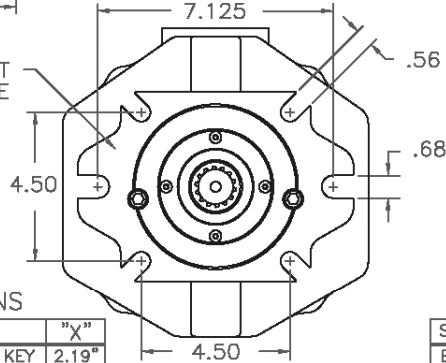

SAE "B" 2 & 4 BOLT MOUNTING FLANGE (6) 1/2-13

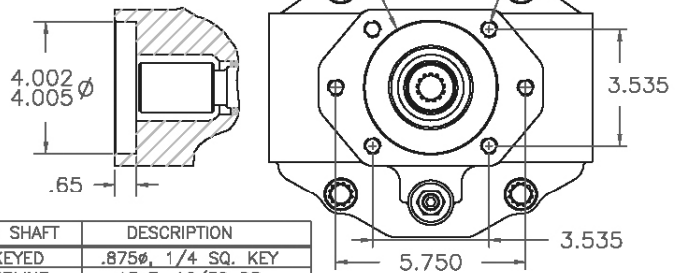

DRIVESHAFT OPTIONS

SAE SHAFT	DESCRIPTION	"X"
C KEYED	1.250 ϕ , 5/16 SQ. KEY	2.19"
C SPLINE	14 T, 12/24 DP	2.19"
C-C KEYED	1.500 ϕ , 3/8 SQ. KEY	2.44"
C-C SPLINE	17 T, 12/24 DP	2.44"

SAE SHAFT	DESCRIPTION
B KEYED	.875 ϕ , 1/4 SQ. KEY
B SPLINE	13 T, 16/32 DP
B-B KEYED	1.000 ϕ , 1/4 SQ. KEY
B-B SPLINE	15 T, 16/32 DP

SAE "A" 2 BOLT MOUNTING FLANGE

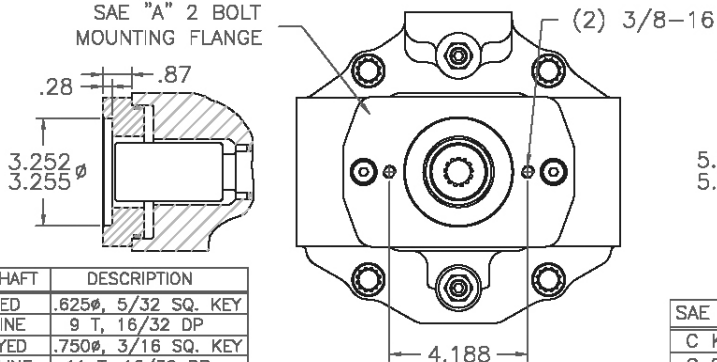

SAE "C" 4 BOLT MOUNTING FLANGE

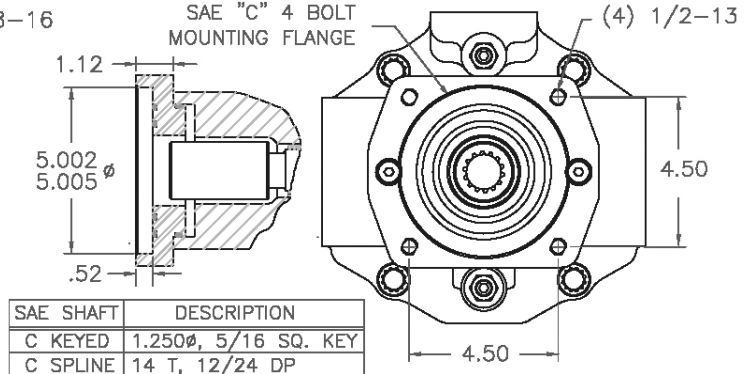

SAE SHAFT	DESCRIPTION
A KEYED	.625 ϕ , 5/32 SQ. KEY
A SPLINE	9 T, 16/32 DP
AB KEYED	.750 ϕ , 3/16 SQ. KEY
AB SPLINE	11 T, 16/32 DP

SAE SHAFT	DESCRIPTION
C KEYED	1.250 ϕ , 5/16 SQ. KEY
C SPLINE	14 T, 12/24 DP