

HARTMANN

PUMPS - MOTORS - CONTROLS

604 Progress Dr., Hartland, WI 53029 USA

Tel: (262) 367-4299

Fax: (262) 367-5645

Email: sales@hartmanncontrols.com

URL: <http://www.hartmanncontrols.com>

FRAME 0

PVX 110-122 SERIES

10 - 22 cm.³/rev.) (0.61 - 1.34 in.³/rev.)

VARIABLE DISPLACEMENT, AXIAL PISTON, SWASH PLATE DESIGN PUMP

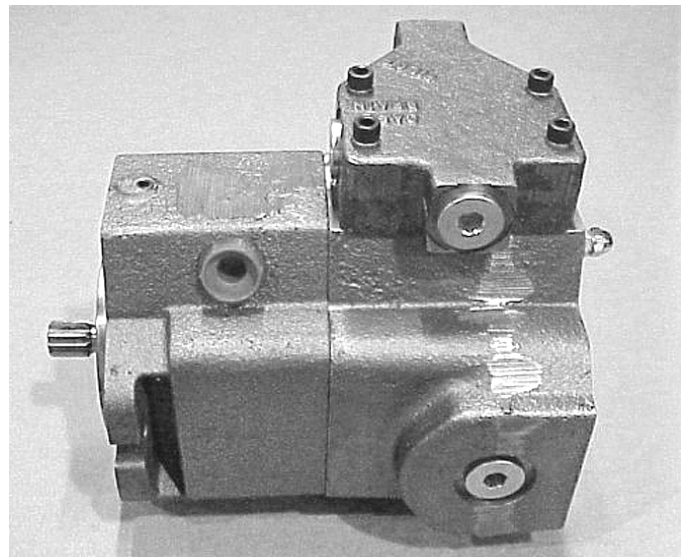
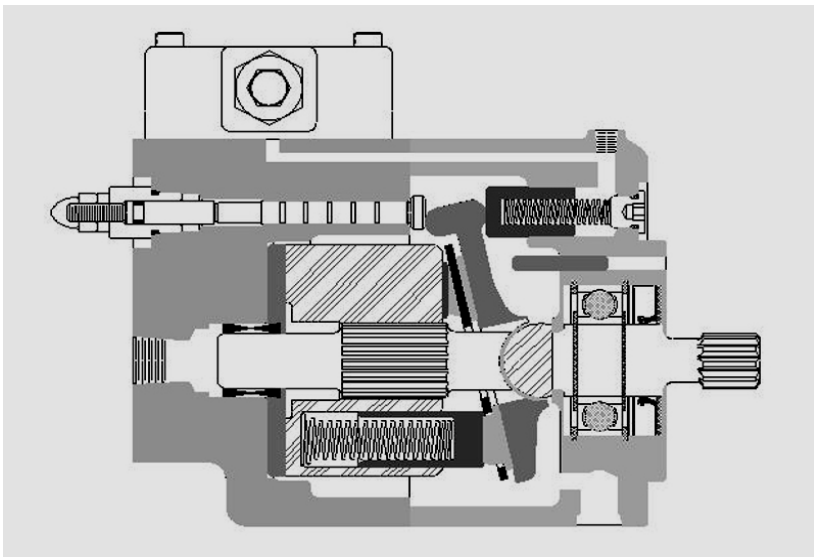

Features:

- ➔ Offered with standard SAE 'A', 2-bolt mount.
- ➔ Incorporated in a compact design with rugged ductile iron frame.
- ➔ Offered with variety of porting configurations.
- ➔ Offered with a variety of drive shaft options.
- ➔ Is Service friendly.
- ➔ Equipped with Viton shaft seal and O-rings.
- ➔ Can be fitted with a variety of control options.
- ➔ Equipped with maximum and minimum volume stops. The latter is adjustable across the full displacement range.

This versatile PVX pump is aimed at operating in both industrial and mobile applications. With its continuous operating pressures ranging from 150 to 3500 psi, and shaft speeds up to 3200 rpm at atmospheric inlet conditions, this pump is designed for a long and dependable service.



Pumps & Motors with a *hart* of gold

TM

FRAME 0, PVX 110-122 SPECIFICATIONS

PVX	RATED PRESSURE	PEAK PRESSURE	MINIMUM PRESSURE	
110	3500 lb/in ² (241 bar)	4000 lb/in ² (276 bar)	150 lb/in ² (10 bar)	
112	3500 lb/in ² (241 bar)	4000 lb/in ² (276 bar)	150 lb/in ² (10 bar)	
114	3500 lb/in ² (241 bar)	4000 lb/in ² (276 bar)	150 lb/in ² (10 bar)	
116	3500 lb/in ² (241 bar)	4000 lb/in ² (276 bar)	150 lb/in ² (10 bar)	
118	3500 lb/in ² (241 bar)	4000 lb/in ² (276 bar)	150 lb/in ² (10 bar)	
120	3500 lb/in ² (241 bar)	4000 lb/in ² (276 bar)	150 lb/in ² (10 bar)	
122	3500 lb/in ² (241 bar)	4000 lb/in ² (276 bar)	150 lb/in ² (10 bar)	

PVX	DISPLACEMENT	THEORETICAL FLOW @ 1800 rpm	SHAFT SPEED	
			MAXIMUM	MINIMUM
110	0.61 in ³ /rev (10 cm ³ /rev)	4.7 gal/min (17.8 l/min)	3200 rpm	600 rpm
112	0.73 in ³ /rev (12 cm ³ /rev)	5.7 gal/min (21.6 l/min)	3200 rpm	600 rpm
114	0.85 in ³ /rev (14 cm ³ /rev)	6.6 gal/min (25.0 l/min)	3200 rpm	600 rpm
116	1.00 in ³ /rev (16 cm ³ /rev)	7.8 gal/min (29.5 l/min)	3200 rpm	600 rpm
118	1.10 in ³ /rev (18 cm ³ /rev)	8.6 gal/min (32.5 l/min)	3200 rpm	600 rpm
120	1.22 in ³ /rev (20 cm ³ /rev)	9.5 gal/min (36.0 l/min)	3200 rpm	600 rpm
122	1.34 in ³ /rev (22 cm ³ /rev)	10.4 gal/min (39.4 l/min)	3200 rpm	600 rpm

PVX	OUTPUT TORQUE @ RATED PRESSURE	SHAFT SIZE	RECOMMENDED TORQUE LIMIT
110	340 in-lb (38.4 N-m)	SAE A	494 in-lb (56.0 N-m)
112	407 in-lb (46.0 N-m)		
114	474 in-lb (53.6 N-m)		
116	557 in-lb (62.9 N-m)	SAE AB	971 in-lb (110.0 N-m)
118	613 in-lb (69.3 N-m)		
120	680 in-lb (76.8 N-m)		
122	747 in-lb (84.4 N-m)		

Input-shaft torque may not exceed the total of front-pump torque and (if added) rear-mounted units.

MODEL SPECIFICATION CHART

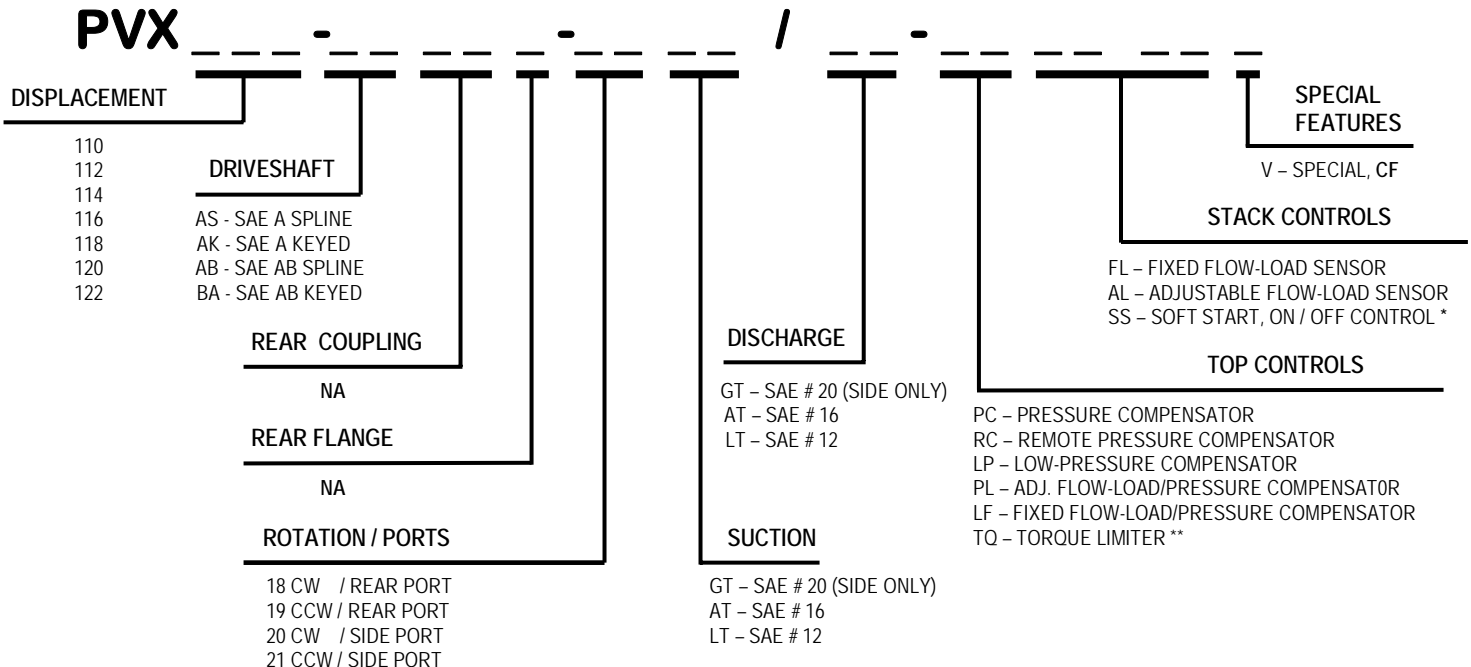

* - SPECIFY VOLTAGE, CONNECTION AND ENERGIZE OPTION

** - SPECIFY TERMINAL PRESSURE AND HORSE POWER

NA - NOT AVAILABLE
CF - CONSULT FACTORY

FRAME 0, PVX 110-122 PERFORMANCE

PVX110 pump performance @ 1750 rpm using ISO 32 oil at 115° F

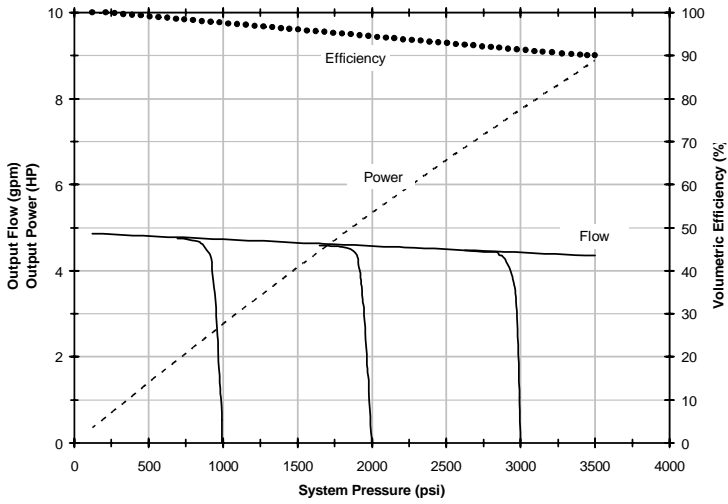

PVX116 pump performance @ 1750 rpm using ISO 32 oil at 115° F

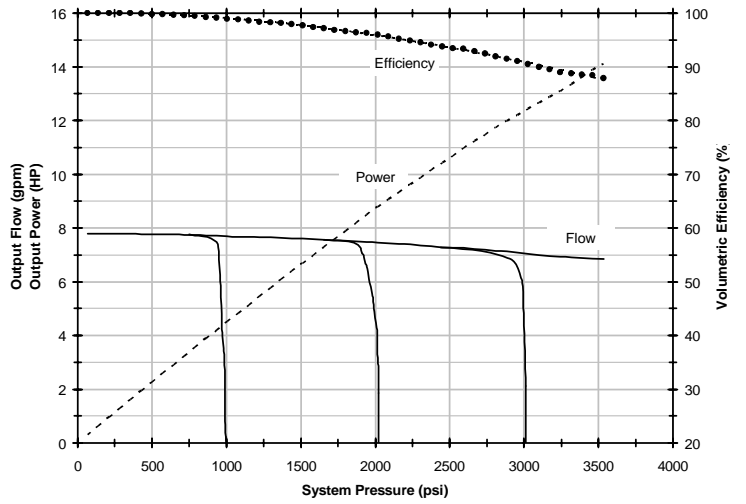

PVX118 pump performance @ 1750 rpm using ISO 32 oil at 115° F

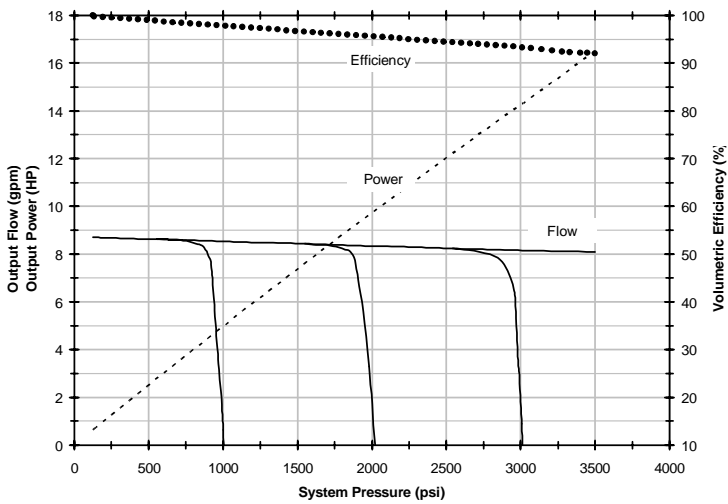

PVX122 pump performance @ 1750 rpm using ISO 32 oil at 115° F

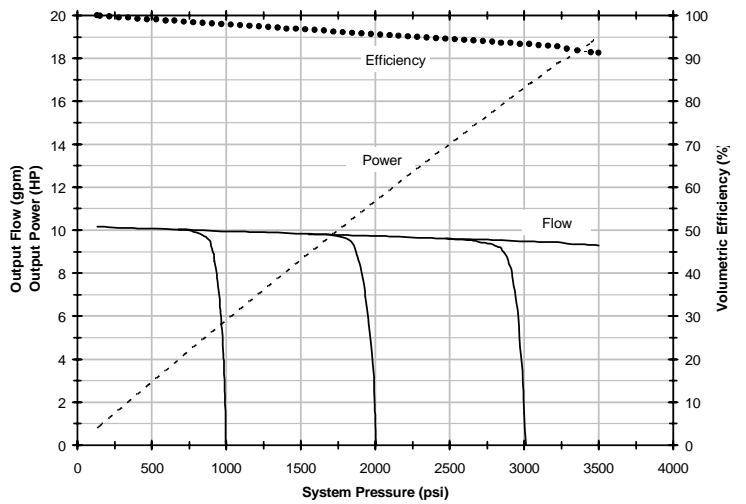

PVX110-122 pump inlet characteristics based on ISO 32 Oil @ 115° F

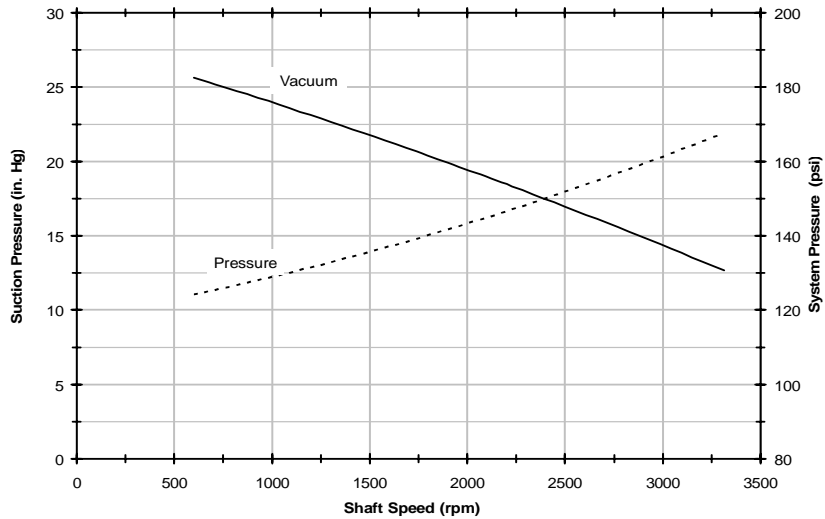

Pump typical weight: Side-Ported 37 lbs. Rear-Ported 35 lbs.

FRAME 0, PVX 110-122 DIMENSIONS

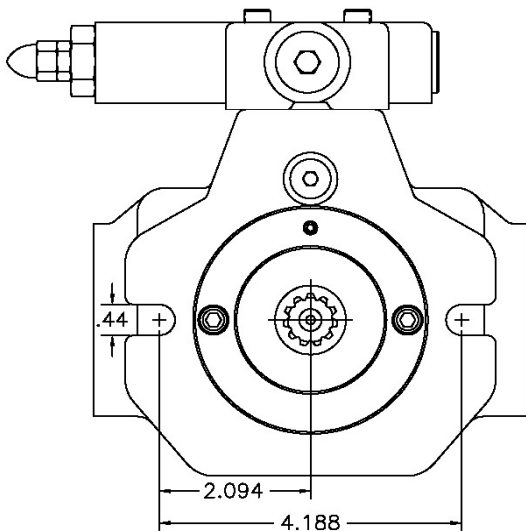
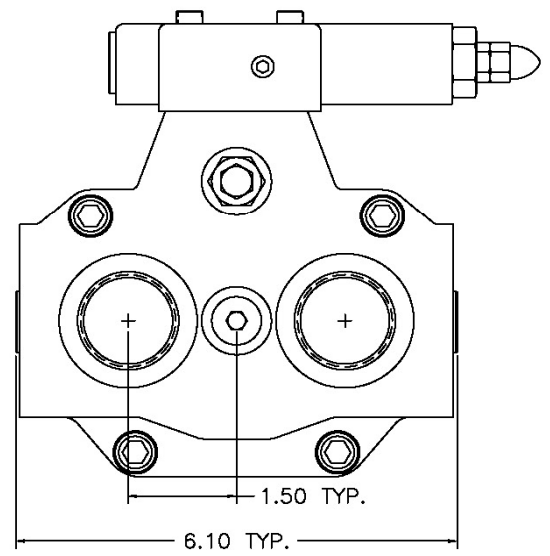
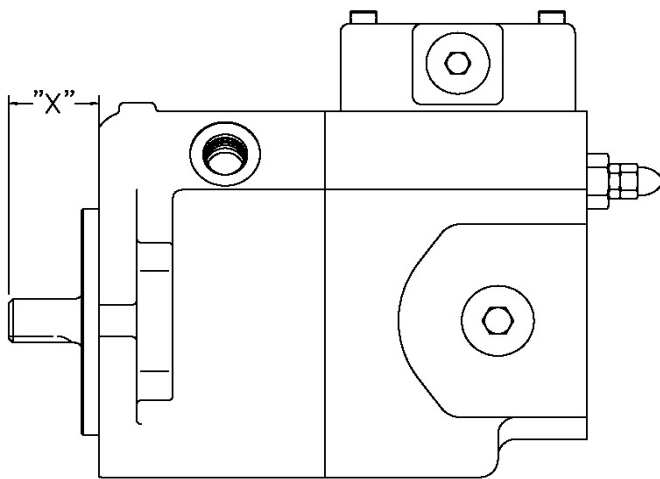
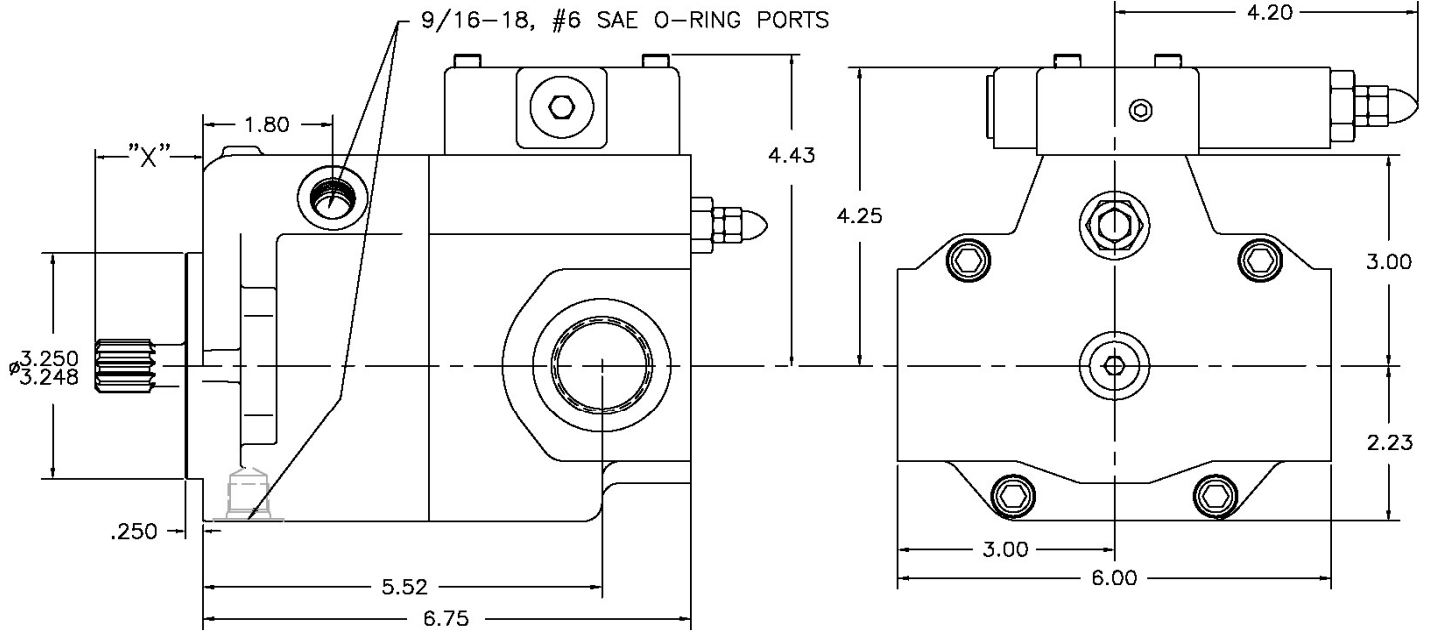

DRIVESHAFT OPTIONS

SAE SHAFT	DESCRIPTION	"X"
A KEYED	.625 ϕ , 5/32 SQ. KEY	1.25
A SPLINE	9 T, 16/32 DP	1.25
AB KEYED	.750 ϕ , 3/16 SQ. KEY	1.25
AB SPLINE	11 T, 16/32 DP	1.49