

HARTMANN
PUMPS - MOTORS - CONTROLS

Detailed Parts for PV300/400 Series Pumps

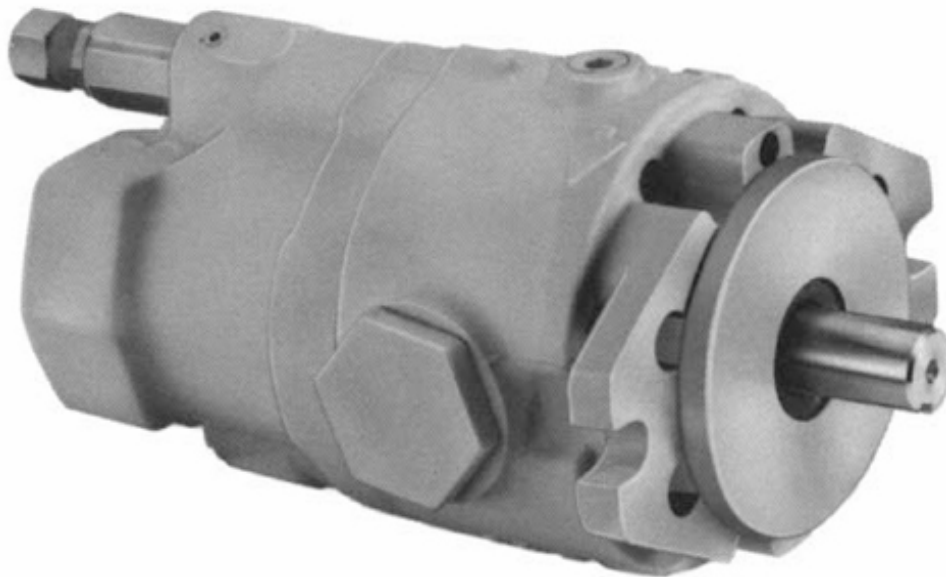

*Hydraulic pumps & motors with a **hart of gold**™*

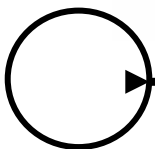

**604 PROGRESS DRIVE, HARTLAND, WI 53029
USA**

Phone: (262) 367-4299

FAX: (262) 367-5645

URL: www.hartmanncontrols.com

E-mail: sales@hartmanncontrols.com

Pump Assembly

1. Compensator Assembly
2. Pipe Plug
3. Spring Seat
4. Starter Spring
5. Piston Spring
6. **Case Dowel (Obsolete)**
7. Piston Assembly
8. Control Piston
9. Snap Ring
10. Hold Down Plate
11. Thrust Plate
12. Reaction Plate
13. Snap Ring
14. Bearing Cup
15. Snap Ring
16. Shaft Seal
17. Snap Ring
18. Key
19. Trunnion Nut
20. O-Ring
21. Needle Bearing
22. Trunnion Thrust Washer
23. Brass Washer
24. Housing Screw
25. Drive Shaft
26. Drive Cover
27. Bearing Cone
28. Lead Plug
29. Pump Null Screw
30. Pipe Plug
31. Housing O-Ring
32. Bronze Rotor
33. Control Piston
34. Valve Plate
35. Dowel Pin
36. Needle Bearing
37. Spacer
38. O-Ring
39. Volume Control Plug
40. Port End Cover
41. **Pipe Plug (Obsolete)**

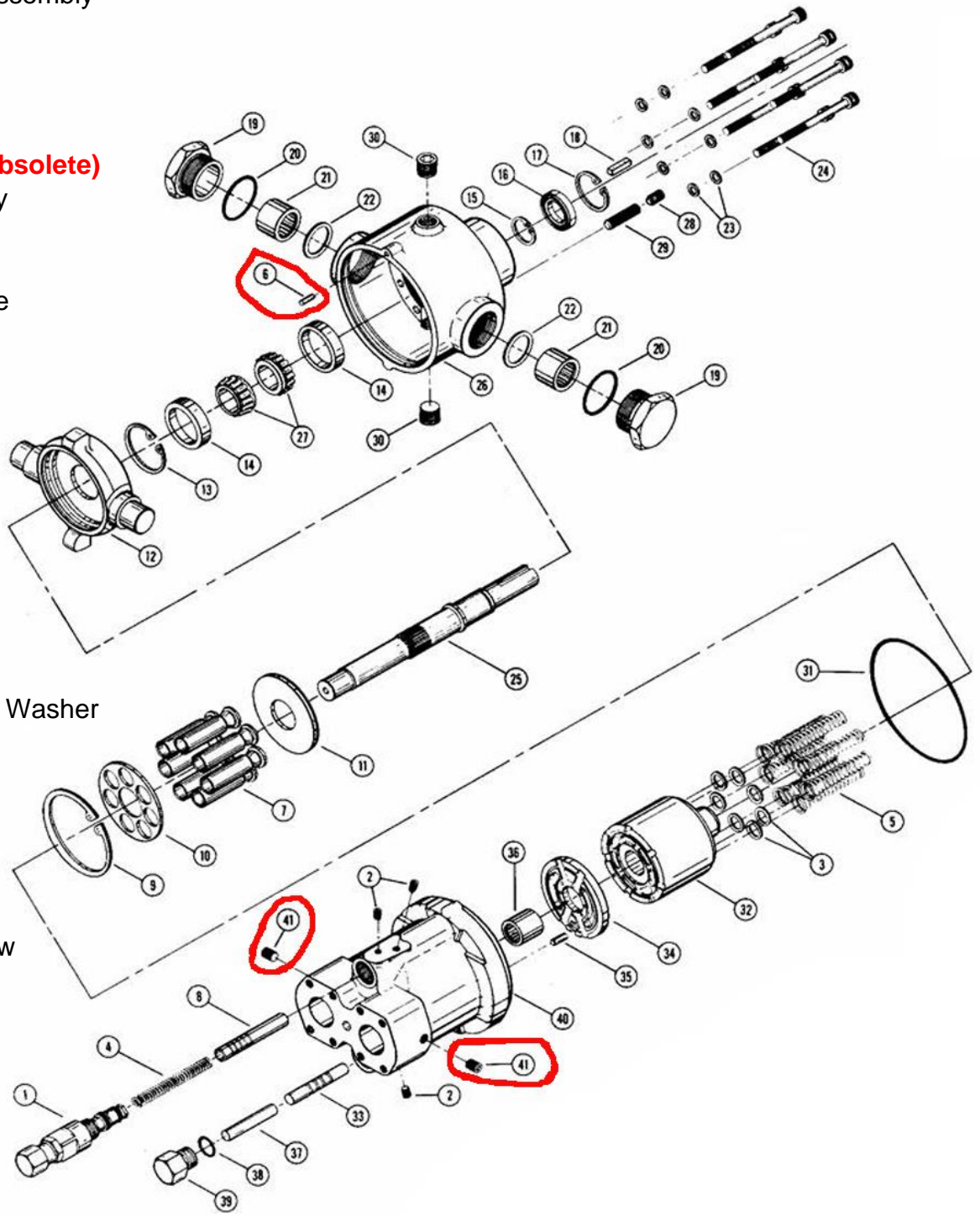

Description	Ref #	Part Number or Kit	
		300 Series	400 Series
PRESSURE COMPENSATOR ASSEMBLY, HIGH RATING (3000 psi)	1	31800-2	
PRESSURE COMPENSATOR ASSEMBLY, LOW RATING (2000 psi)		31740-2	
PIPE PLUG (3)	2	25080	
SPRING SEAT (7)	3	Kit 34380	Kit 34381
STARTER SPRING	4	Kit 35640	
PISTON SPRING (7)	5	Kit 34380	Kit 34381
CASE DOWEL PIN, OBSOLETE	6	32290-13	
PISTON ASSEMBLY (7)	7	Kit 34380	Kit 34381
ON-STROKE CONTROL PISTON	8	Kit 35640	
SNAP RING FOR HOLD DOWN PLATE	9	Kit 34380	Kit 34381
HOLD DOWN PLATE	10	Kit 34380	Kit 34381
THRUST PLATE	11	Kit 34380	Kit 34381
REACTION PLATE	12	Kit 34382-1	
SNAP RING FOR THE BORE	13	Kit 53432	
BEARING CUP (2)	14	Kit 53432	
SNAP RING FOR THE SHAFT	15	Kit 53432	
SHAFT SEALS			
SHAFT SEAL (1-1/8" Φ SHAFT), VITON	16	Kit 34290-2	
SHAFT SEAL (1-1/4" Φ SHAFT), VITON		Kit 34290-2	
SNAP RING FOR SEAL SIDE	17	Kit 53432	
KEY (1/4" SQ. X 1.25", 1-1/8" Φ SHAFT)	18	25075	
KEY (5/16" SQ. X 1.12", 1-1/4" Φ SHAFT)		32353	
TRUNNION NUT (2)	19	28563	
O-RING (2)	20	Kit 34290-2	

Description	Part Number	
	Ref #	300 Series 400 Series
NEEDLE BEARING (2)	21	Kit 53432 or Kit 51100
TRUNNION THRUST WASHER (2)	22	Kit 34382-1
BRASS WASHER (8)	23	16646
HOUSING SCREW (8)	24	16645
DRIVE SHAFTS		
DRIVE SHAFT 1-1/8" Φ , STANDARD	25	28562
DRIVE SHAFT 1-1/8" Φ , WATERBASE		37137
DRIVE SHAFT 1-1/4" Φ SAE-C KEYED, STANDARD		38755
DRIVE SHAFT 1-1/4" Φ SAE-C KEYED, WATERBASE		51257
DRIVE SHAFT 1-1/4" Φ SAE-C SPLINED, STANDARD		29594
DRIVE SHAFT 1-1/4" Φ SAE-C SPLINED, WATERBASE		38062
DRIVE SHAFT 1-1/8" Φ , SPECIAL (TAPERED & THREADED)		29501
DRIVE SHAFT 1-1/4" Φ , SPECIAL (LONG KEY; 1-1/2" LONGER)		32352
DRIVE COVERS		
DRIVE COVER, DUCTILE IRON, CW	26	28574
DRIVE COVER, DUCTILE IRON, CCW		28574-L
DRIVE COVER, WATERBASE		37738
BEARING CONE (2)		
BEARING CONE (2)	27	Kit 53432
LEAD PLUG	28	27615
POSITIVE-STOP SET SCREW	29	27614
PIPE PLUG	30	17367



PV 300 & 400 SERIES PUMP PARTS

Description		Part Number	
		Ref #	300 Series 400 Series
O-RING	31	Kit 34290-2	
BRONZE ROTOR	32	Kit 34380	Kit 34381
VOLUME CONTROL PISTON	33	16614	
VALVE PLATE, CW	34	32028	
VALVE PLATE, CCW		32029	
VALVE PLATE, BI-DIRECTIONAL		31991	
DOWEL PIN	35	16647	
NEEDLE BEARING (REAR)	36	Kit 53432	
SPACER (XX DEFINES VOLUMETRICS)	37	35573 - XX	
O-RING	38	Kit 34290-2	
VOLUME CONTROL PLUG SUB-ASSEMBLY	39	51101	
PORT END COVERS			
PEC, CW, STANDARD, 320 & 420, 21, 24, 25	40	28539	
PEC, CCW, STANDARD, 320 & 420, 21, 24, 25		29157	
PEC, CW, SAE # 24 PORTS, 320 & 420, 21, 24, 25		29158	
PEC, CCW, SAE # 24 PORTS, 320 & 420, 21, 24, 25		29159	
PEC, CW, WATERBASE, 320 & 420		37138	
PEC, CCW, WATERBASE, 320 & 420		37453	
PEC, MOTORS, PF, 300 & 400		28541	
PEC, BI-DIRECTIONAL, 330 & 430		29372	
PEC, CW OR BI-DIRECTIONAL, 340 & 440		29373	
PEC, CCW, 340 & 440		29374	
PEC, BI-DIRECTIONAL, 340 & 440		29375	
PEC, BI-DIRECTIONAL, SAE # 24, 340 & 440		33030	



PV 300 & 400 SERIES PUMP PARTS

Description		Part Number		
PORT END COVERS		Ref #	300 Series 400 Series	
PEC, CW, SPECIAL, 440	40		51204	
PEC, CW, 310 & 410		36532		
PEC, CCW, 310 & 410		36531		
PEC, CW, SAE # 24 PORTS, 310 & 410		37833		
PEC, CCW, SAE # 24 PORTS, 310 & 410		51126		
PIPE PLUG (OBSOLETE)	41	16639		
VOLUME/DISPLACEMENT CONTROLS				
NON-ADJUSTABLE CONTROL		51101		
ADJUSTABLE CONTROL, SHORT SCREW		51102		
ADJUSTABLE CONTROL, LONG SCREW		51455		
CONTROL LIMIT ASSEMBLY, 340 & 440 [SEE NOTE #1]		51148		
CONTROL LIMIT ASSEMBLY, 330 & 430		51128		
CONTROL PISTON		51129		
CONTROLS		300 Series	400 Series	
HANDWHEEL VOLUME CONTROL, 310 & 410		28585		
PRESSURE COMPENSATOR, 320 & 420		31800-2		
LOW PRESSURE COMPENSATOR, 320 & 420		31740-2		
HANDWHEEL PRESSURE COMPENSATOR, 321 & 421	51103			
HI-LO VOLUME CONTROL, 320 & 420, 24, 30	31765-1 or -2			
REMOTE PRESSURE COMPENSATOR, 324 & 424	33926			
DIFFERENTIAL PRESSURE ASSEMBLY, 325 & 425	34548			



PV 300 & 400 SERIES PUMP PARTS

Part Number Description		Part Number
VARIOUS PARTS		
EXTENDED TRUNNION NUT SUB-ASSEMBLY		51106
SAE C MOUNT		33654
SAE C MOUNT, WATERBASE		39092
FOOT MOUNT		33269

NOTE #1: USE CONTROL PISTON 19021 AND INSERT 23311 (2 EACH)