

1. VALVE PLATE
2. DOWEL PIN
3. NULL CONTROL PISTON
4. STARTER SPRING
5. VOLUME CONTROL PISTON
6. INNER STEM BACKUP RING (2)
7. INNER STEM O-RING (2)
8. NULL ADJUST STEM
9. VOLUME ADJUST STEM
10. OUTER STEM O-RING (2)
11. OUTER STEM BACKUP RING (2)
12. PORT END COVER GASKET
13. PORT END COVER
14. JAM NUT (2)
15. PORT END COVER BOLT (4)
16. HYDRAULIC CONTROL(S) [OPT.]
17. HYDRAULIC CONTROL(S) BOLT (4)
18. SWASHPLATE BEARING
19. ROLLER BOLT (2)
20. SIDE PLATE (2)
21. SIDE PLATE SCREW (4)
22. SWASHPLATE
23. HOLD DOWN SPACER (4)
24. HOLD DOWN CLIP (2)
25. HOLD DOWN CLIP WASHER (4)
26. HOLD DOWN CLIP BOLT (4)
27. ROLLER (2)
28. PISTON ASSEMBLY (7)
29. RETAINER PLATE
30. PISTON SPRING (7)
31. ROTOR
32. DRIVE COVER SNAP RING (3)
33. DRIVESHAFT SEAL
34. DRIVESHAFT SNAP RING
35. ROLLER BEARING CUP (2)
36. ROLLER BEARING CONE (2)
37. DRIVESHAFT
38. NEEDLE BEARING
39. INBOARD TRUNNION BOLT (2)
40. BRASS WASHER (2)
41. DRIVE COVER
42. CASE DRAIN O-RING PLUG
43. INBOARD TRUNNION (2)

NOTE:

THE NEWEST VERSION OF HOLD-DOWN CLIPS CONSISTS OF PARTS #23 & #24 AND REPLACES THE SET SHOWN.

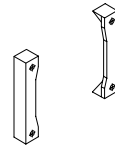

NOT TO SCALE

THE INFORMATION CONTAINED HEREIN IS THE PROPERTY OF HARTMANN CONTROLS INC., AND IS NOT TO BE USED IN A MANNER DETRIMENTAL TO HARTMANN CONTROLS INC.

DWG: PVXFR1360IS

TITLE: PVX 360
VARIABLE
DISPLACEMENT
AXIAL PISTON PUMP

